

# Telemedicine App "Clinics" registration method

Since the CLINICS application is only available in Japanese, we recommend that you register on your browser.

1) Please translate using Chrome's translation function.

For SP

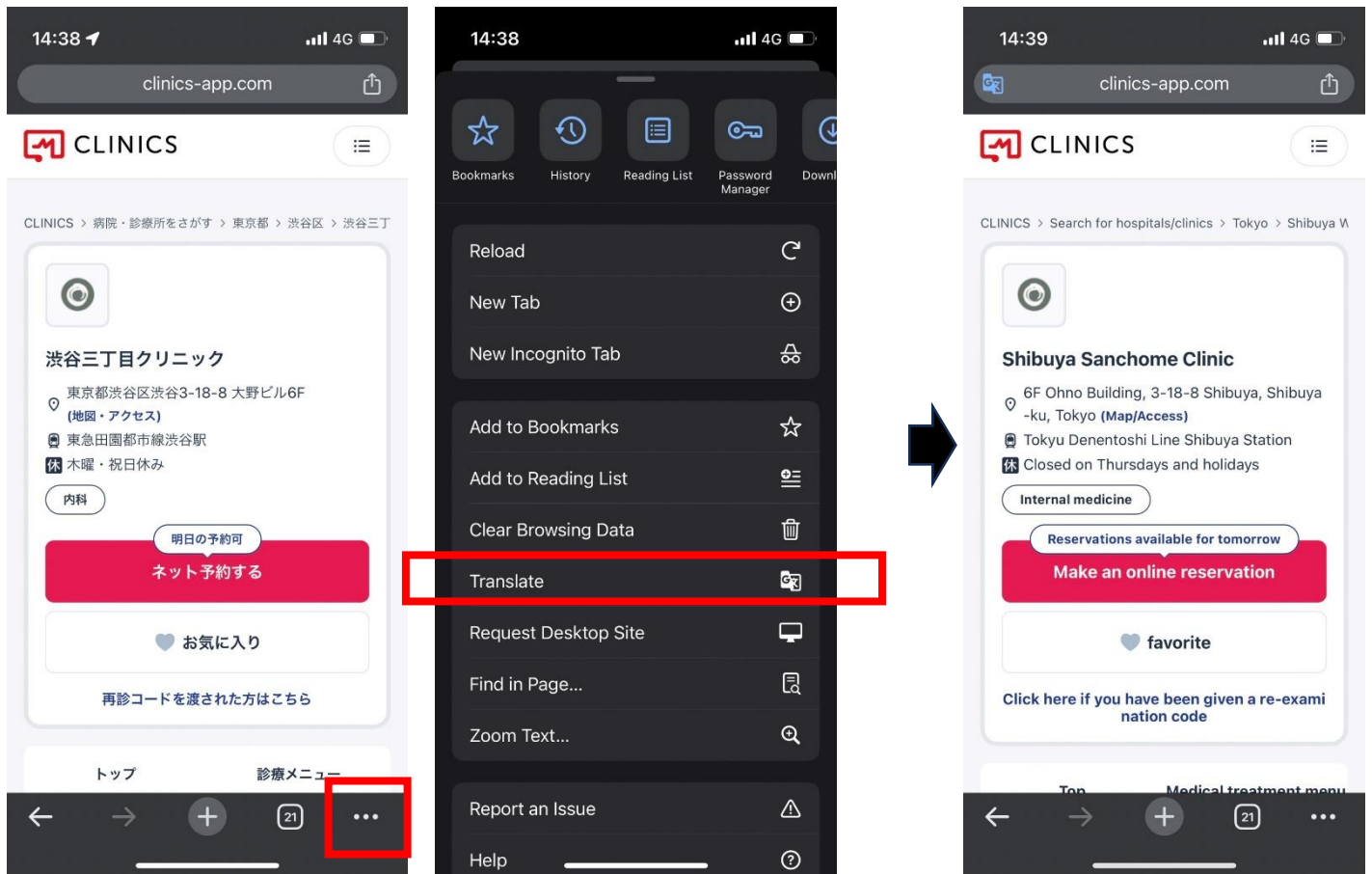

For PC

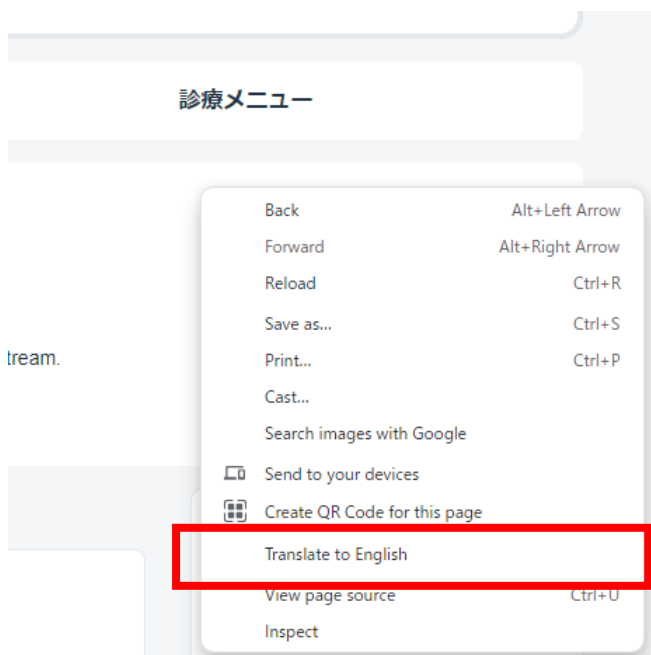

2) Click on "Make an online reservation"

 Hospital/Clinic    pharmacy

CLINICS > Search for hospitals/clinics > Tokyo > Shibuya Ward > Shibuya Sanhome Clinic



### Shibuya Sanhome Clinic

📍 6F Ohno Building, 3-18-8 Shibuya, Shibuya-ku, Tokyo [\(Map/Access\)](#)

🚶 Tokyu Denentoshi Line Shibuya Station

🛑 Closed on Thursdays and holidays

Internal medicine

Reservations available for tomorrow

**Make an online reservation**

♥ favorite

Click here if you have been given a re-examination code

3) Please choose your desired menu.

### Shibuya Sanhome Clinic Medical Menu

#### ED (erectile dysfunction) outpatient clinic

Self-pay medical treatment■ Online medical treatment available

Reservation fee (tax included) **0 Yen**

##### Introduction to online medical treatment

This medical treatment menu is free medical treatment. There is no reservation fee. If you are prescribed medication, you will need to pay for the medication separately. Consultation fees are free. \*Medicine cost varies slightly depending on the medicine used, but it ranges from 550 yen to 2,000 yen per tablet.

Reservations available for tomorrow

**view the details**

#### AGA (thinning hair) outpatient clinic

Self-pay medical treatment■ Online medical treatment available

Reservation fee (tax included) **0 Yen**

##### Introduction to online medical treatment

This medical treatment menu is free medical treatment. Reservation fees and consultation fees are free. Medication costs will be charged separately. Treatment costs vary slightly depending on the medicine used, but are approximately 3,800 yen to 8,000 yen for one month. Shipping fee is 500 yen for orders under 10,000 yen, and free shipping for orders over 10,000 yen.

Reservations available for tomorrow

**view the details**

4) Click on "Make an online reservation"

ED (erectile dysfunction) outpatient clinic

online face to face

Self-pay medical treatment **Online medical treatment available**

**Introduction**

This medical treatment menu is free medical treatment. There is no reservation fee. If you are prescribed medication, you will need to pay for the medication separately. Consultation fees are free. \*Medicine cost varies slightly depending on the medicine used, but it ranges from 550 yen to 2,000 yen per tablet.

**Reservation fee (tax included)**

0 Yen

reservation empty slot	fire 10/17	water 10/18	wood 10/19	Money 10/20	soil 10/21	Day 10/22	Month 10/23
	×	○	×	×	○	○	○

Reservations available for tomorrow

**Make an online reservation**

5) Click on "Online medical treatment"

< return

## Selection of examination method

reservation Interview confirmation

Please select your desired treatment method

**Online medical treatment**

6) Select date and time.

### Select date and time

reservation Interview confirmation

Please select the date and time to book

< previous week 2023 next week >

Oct  
Ob  
er

	17 fire	18 water	19 wood	20 Monday	twenty one soil	twenty two Day	twenty three Month
11:30	×	×	×	×	●	●	●
12:00	×	●	×	×	●	●	●
12:30	×	●	×	×	●	●	●
13:00	×	●	×	×	●	●	●
13:30	×	×	×	×	×	×	×
14:00	×	×	×	×	×	×	×
14:30	×	×	×	×	×	×	×
15:00	×	×	×	×	×	×	×
15:30	×	●	×	×	●	●	●
16:00	×	●	×	×	●	●	●
16:30	×	●	×	×	●	●	●
17:00	×	●	×	×	●	●	●
17:30	×	●	×	×	●	●	●

7) Register an account and make a reservation.

### Login

To make a reservation, you must log in or register for an account.  
Click "Login", "Account Registration", and "Login with d Account" to access CLINIC  
S. [terms of service](#) and [privacy policy](#) you agree to

**Log in and book**

**Log in and reserve with d account**

**Register an account and make a reservation**

If you have any problems, please contact us. [support](#) Please contact us at